



RECLAIM



Understanding the values and significance of the GBGI of the canals and canalsides in Digbeth, Birmingham, UK.

Dr Miguel Hincapié Triviño

Lecturer in Urban Planning

Birmingham City University

miguel.hincapietrivino@bcu.ac.uk



Project Aims

- » **To assess how local actors and organisations assign value and contribute to the significance of the GBGI of canals and canalsides in Digbeth, Birmingham, UK, as a means for urban conservation.**

- » **Objectives:**

- » To analyse how local cultural and civic organisations value GBGI.
- » To assess how these values influence their current activities for conservation.
- » To evaluate ways in which such values and contributions can support planning policy and practice.

Conceptual framework

- » Relational approaches based on cultural landscape theories advocating the constantly changing nature of social values (Mason, 2000).
- » Cultural landscapes as a result of the interaction between *Forms, Practices and Processes* and their *Relationships* (Stephenson, 2008)

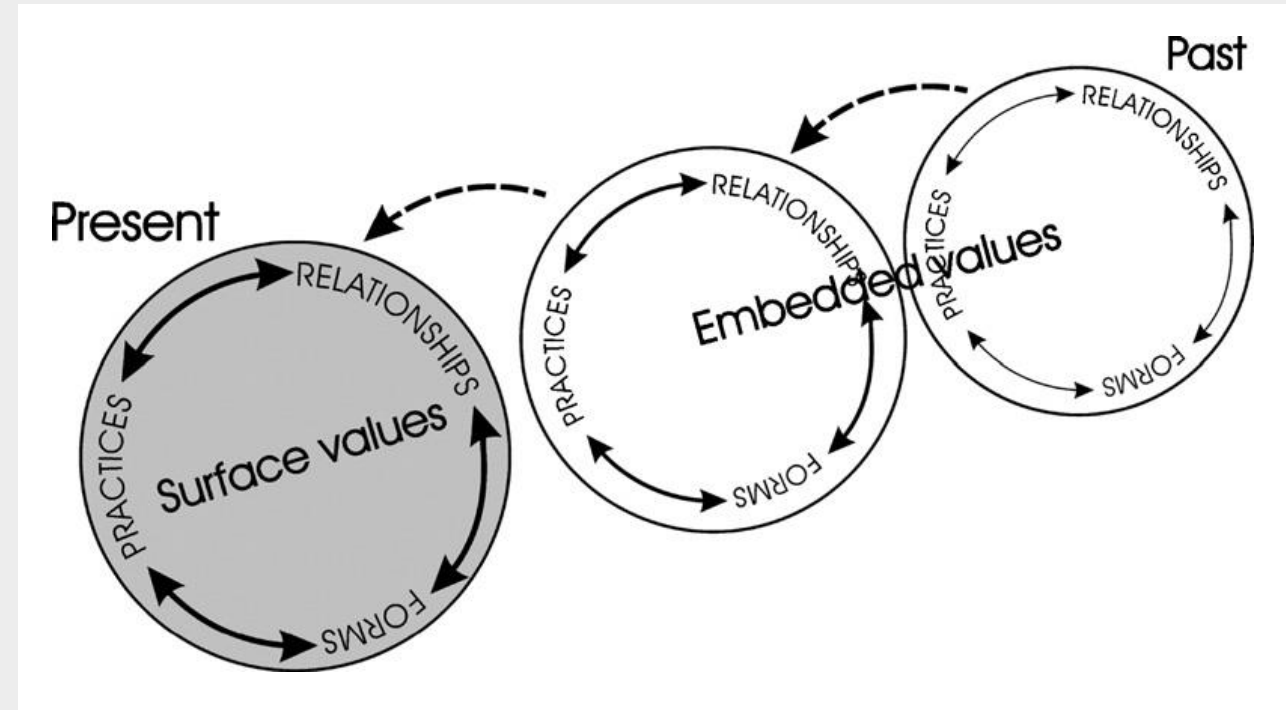

The Cultural Values Model, showing surface and embedded values (Stephenson, 2008).

Practices and processes in GBGI

‘Reabsorption’ engaged with the soil as a living ecosystem that comprises the economic and cultural inheritance of Digbeth.



Photo by Grand Union, 2022

The Minerva Apothecary Garden has been created alongside the Grand Union canal, next to Grand Union Gallery and Studios.



Photo by Nina Baillie, 2021

Research Methods: Photovoice



RECLAIMING THE CANALS



A participatory
photography
workshop
on Digbeth's
industrial landscapes.

13.10.23
9:00 - 13:30
(Lunch included)

STEAMhouse
Belmont Row
Birmingham B4 7RQ

Part of the research project titled: "Understanding the value and significance of the Green, Blue and Grey infrastructure of the canals and canalsides in Digbeth, Birmingham", led by Dr. Miguel Hincapié at Birmingham City University. For more information and registration: <https://rb.gy/3tex2>.

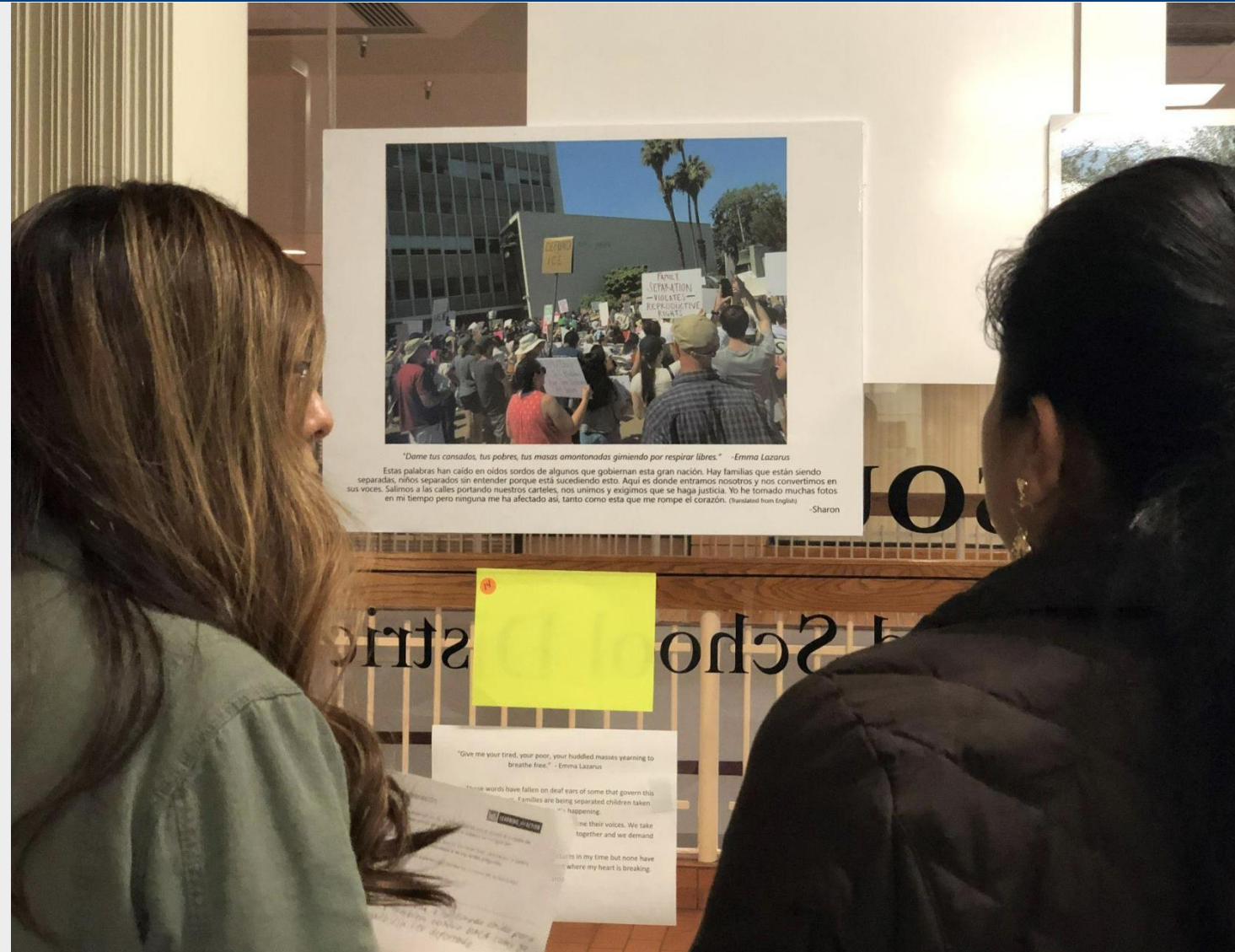
This work has been kindly supported by the UKRI-funded RECLAIM Network Plus grant (EP/W034034/1).



Expected outcomes and benefits

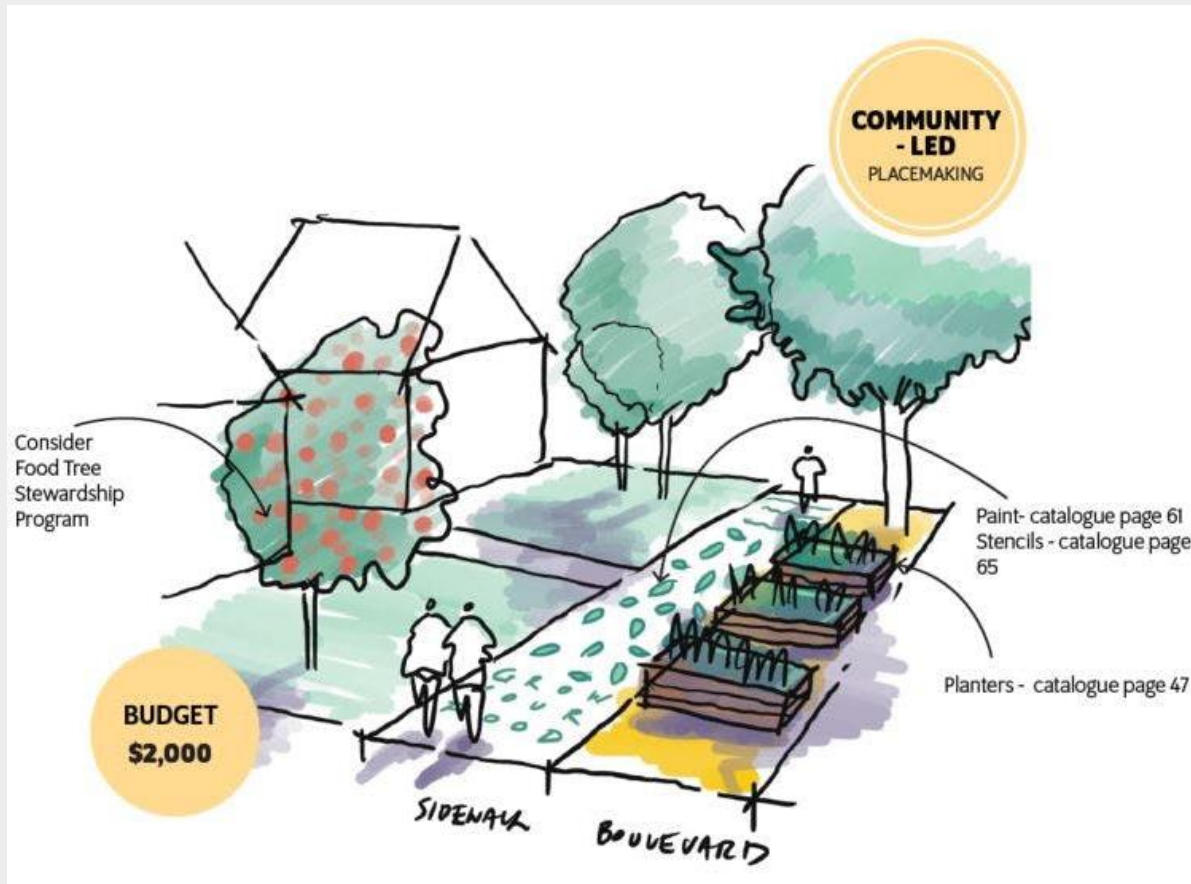

- To develop a toolkit to narrow down the potentials of these GBGI, the values assigned by local communities, and the potential activities.
- To support updates and revisions of instruments such as the Digbeth, Bordesley and Warwick Bar Conservation Area Appraisals.
- To support decision-making and inclusion of local-based values and activities in Birmingham's 'Our Future City' Plan.